

NATURAL GAS SIDE-BURNER CONVERSION PROCEDURE

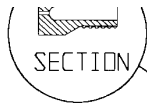

INJECTOR



Step 1 Remove LPG injector and replace with 1.6mm Natural Gas Injector

SECTION AA

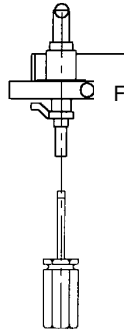
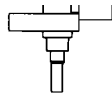

Fine Screwdriver

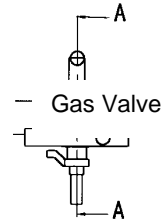

Step 2 Turn adjustment screw (inside spindle) 120° Counter clockwise with a flat head needle screwdriver

120°

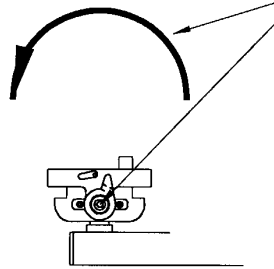

Step 3 Place the round black 'NATURAL GAS' lable over the red 'LPG' lable underneath the side burner